

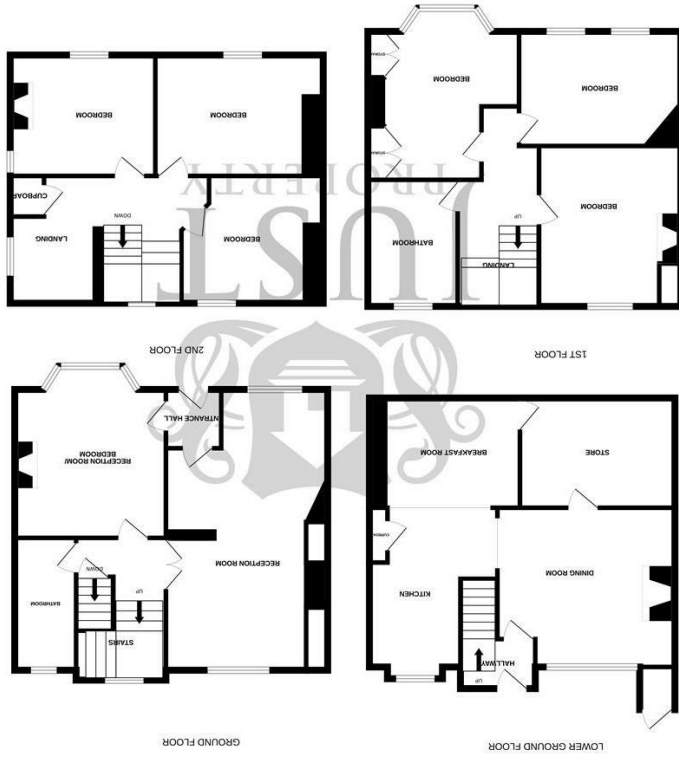

Whilst every attempt has been made to ensure the accuracy of the floorplan contained here, measurements of doors, windows, rooms and any other items are approximate and no responsibility is taken for any omission or mis-statement. This plan is for illustrative purposes only and should be used as such by any prospective purchaser. The services, systems and appliances shown have not been tested and no guarantee as to their operability or efficiency can be given.
Made with Metropix ©2026



Kent House, 4 High Street, Old Town, Hastings, TN34 3EY

FLOORPLANS

www.justproperty.net

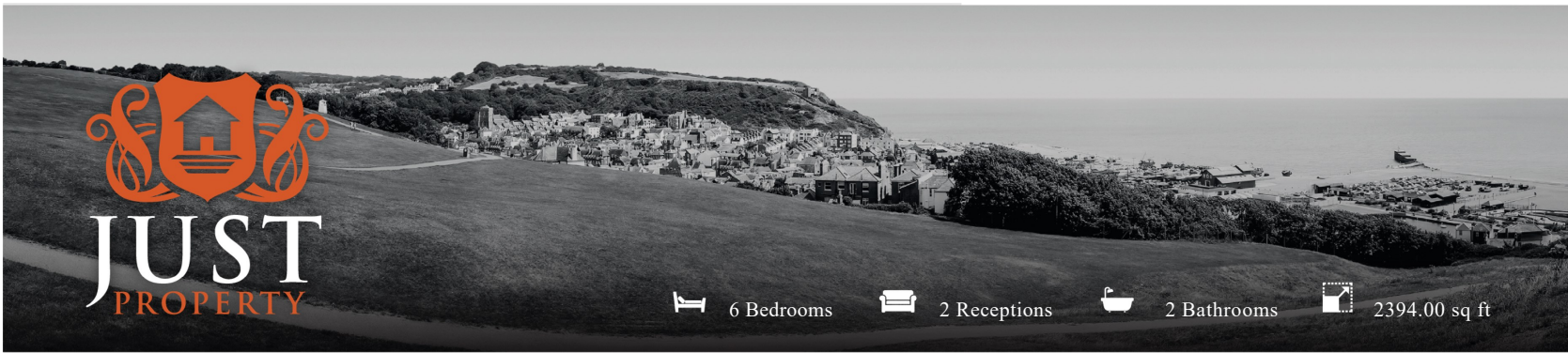

6 Bedrooms 2 Receptions 2 Bathrooms 2394.00 sq ft

Freehold
£695,950

Kent House, 4 High Street, Old Town, Hastings, TN34 3EY





6 Bedrooms 2 Receptions 2 Bathrooms 2394.00 sq ft

PROPERTY DETAILS

Positioned in the heart of Hastings' historic Old Town, Kent House enjoys a highly desirable setting just a short walk from the beach, East Hill, and Hastings Country Park. A vibrant mix of independent shops, galleries, cafés, and traditional pubs are all close by, while Hastings town centre and a mainline railway station with direct links to London are also within easy reach.

This substantial six-bedroom Grade II listed period home offers a rare opportunity to acquire a property rich in history and character. Dating back to the late 17th century and once owned by local surgeon and developer Samuel Satterley, it retains many original features including exposed beams, bay windows, and feature fireplaces.

Arranged over four floors, the accommodation is spacious and versatile. The ground floor includes a large dual-aspect living room with fireplace and panelling, along with a second reception room/bedroom and a bathroom. The lower ground floor offers a fitted kitchen opening into a dining room with original flagstone flooring and an inglenook fireplace, plus access to the garden and a large useful store.

The upper floors provide six double bedrooms, some with built-in storage and rear-facing rooms enjoying sea views, along with a family bathroom.

Outside, there is an enclosed walled garden with a patio area leading from the kitchen and a lawn bordered by mature planting. A much-loved family home 50 years, offering charm, space, and an exceptional location.

Kent House, does require some updating and can be viewed with the sole agents, Just Property.



ROOM DIMENSIONS

Front Door	Principle Bedroom
Entrance Hallway	13'8" x 12'0" (4.17 x 3.68)
Reception Room	Bedroom
24'7" x 13'2" (7.50 x 4.02)	14'9" x 12'10" (4.50 x 3.93)
Reception Room / Bedroom	Bedroom
15'1" x 12'10" (4.60 x 3.93)	13'9" x 9'9" (4.21 x 2.98)
Stairs Down to Garden Level	Bathroom
Hallway	Stairs Up To Landing/Office Area
Dining Room	Bedroom
15'1" x 14'2" (4.61 x 4.34)	14'3" x 10'4" (4.36 x 3.15)
Kitchen	Bedroom
14'7" x 10'11" (4.45 x 3.33)	12'0" x 10'10" (3.68 x 3.31)
Storage Room	Bedroom
Breakfast Room	12'4" x 10'4" (3.77 x 3.15)
12'9" x 9'8" (3.91 x 2.96)	Rear Garden
Stairs up To	Patio Area

FEATURES

- Fantastic Period Property
- 17th Century Family Home
- Six Bedrooms
- Wonderful Mature Walled Garden
- Great Views Towards English Channel
- Many Period Features Retained
- Hastings Old Town Location
- Two Bathrooms

